

# **APEX** **Xtraflo**<sup>TM</sup> **TROUGH VALVE**

Quality Endorsed Company  
ISO 9001  
Licence 4886

- **Full flow – diaphragm activated**
- **Armless – reducing stock damage**
- **Above water float adjustment**
- **Self-cleaning valve mechanism to minimise blockage**
- **Float buoyancy equal to 6" round float**
- **Cord cleat for shutting off valve**
- **Bottom or Side Mount**

**1 1/2" water level differential from open to close**

**Minimum inlet pressure 5 PSI**

**Maximum inlet pressure 150 PSI**

- **Available in 3 sizes:**

**3/4" (XF 3/4),**

**1" (XF 1) and**

**1 1/4" (XF 1 1/4)**



**BOTTOM ENTRY**

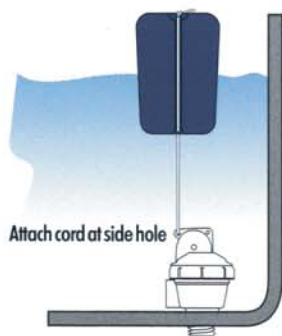

**SIDE ENTRY**

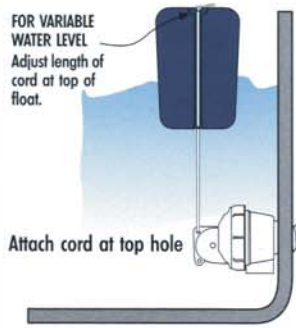

**TRU-TEST®**

**COMPACT • NON-CORROSIVE  
RELIABLE • SIMPLE TO INSTALL  
NO FLOAT ARM TO DAMAGE**

# **Xtraflo** TROUGH VALVE *Long Tail*

- Full flow – diaphragm activated
- Cord cleat for shutting off valve
- No additional fittings required
- Self-cleaning valve mechanism to minimise blockage
- Above water float adjustment
- Armless – reducing stock damage

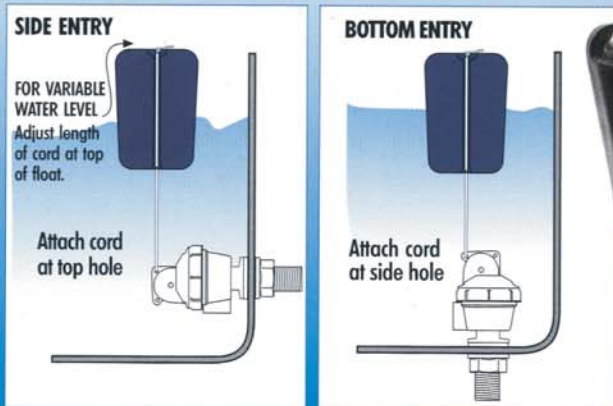

**XFLT 3/4 3/4"**  
 Float buoyancy equal to 6" round float  
 1 1/2" water level differential from open to close  
 Minimum inlet pressure 5 PSI (35 kPa)  
 Maximum inlet pressure 150 PSI (1000 kPa)

# **Xtraflo** TROUGH VALVE **Anti-Siphon Conversion Kit**

- For Top Entry installation
- Adjustable Arm for ideal water level
- Fits all Xtraflo Valves
- Simple to install



**XF TEK**

**TRU-TEST®**

Distributed by: Tru-Test, Inc., Mineral Wells, TX 76067  
 Free phone: 1-800-874-8494 [www.tru-test.com](http://www.tru-test.com)  
 Manufactured by: Apex Valves Ltd, Auckland, New Zealand